

HabasitLINK[®] M5032 Roller Top 2"



Your Source For Habasit
Belting And Chain

www.StilesEnterprises.com • 1-800-325-4232

Description

- Strong design
- 33 % open area; largest opening 6.4x8.5 mm (0.25"x0.33")
- Rollers row spacing 50.8 mm (2")
- For low back pressure, wearstrips are placed between rollers
- For product driven application wearstrips are placed directly under the rollers
- Excellent for flushing and draining
- Closed hinge
- Food approved materials available
- Rod diameter 7 mm (0.27")

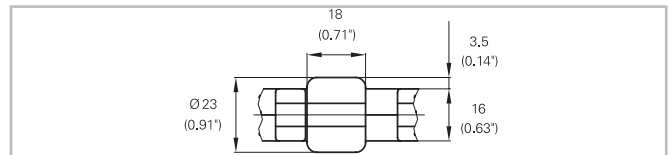
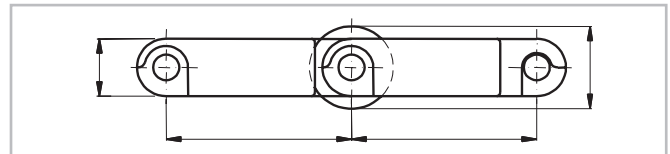
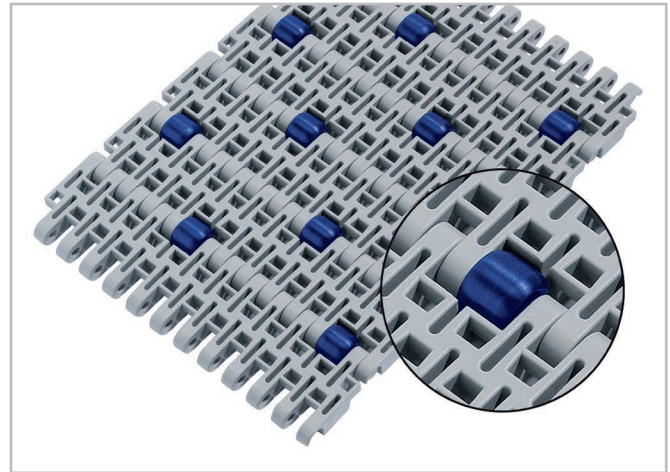

Belt data

Belt material		PP				POM	
Rod material		PP		PA			
Roller material		POM					
Roller lateral spacing per row	mm / inch	112 / 4.4	150 / 6	112 / 4.4	150 / 6	112 / 4.4	150 / 6
Roller offset next row	mm / inch	56 / 2.2	75 / 3	56 / 2.2	75 / 3	56 / 2.2	75 / 3
Roller dimension diameter / width	mm inch	Ø 23 / 18 Ø 0.91 / 0.71	Ø 23 / 18 Ø 0.91 / 0.71	Ø 23 / 18 Ø 0.91 / 0.71	Ø 23 / 18 Ø 0.91 / 0.71	Ø 23 / 18 Ø 0.91 / 0.71	Ø 23 / 18 Ø 0.91 / 0.71
Nominal tensile strength F' _N straight run	N/m lb/ft	24000 1644	27000 1850	25000 1712	28000 1918	36000 2446	41000 2809
Temperature range	°C °F	5 - 93 40 - 200	5 - 93 40 - 200	5 - 93 40 - 200	5 - 93 40 - 200	-40 - 93 -40 - 200	-40 - 93 -40 - 200
Belt weight m _B	kg/m ² lb/sqft	8.0 1.64	8.0 1.64	8.0 1.64	8.0 1.64	12.0 2.46	12.0 2.46

Diameter of idling rollers (minimum)		Diameter of support rollers (minimum)		Diameter for gravity take-up and center drive rollers (minimum)		Backbending radius for elevators without side guards or hold down devices (minimum)		Backbending radius for elevators with sideguards or hold down devices (minimum)	
mm	inch	mm	inch	mm	inch	mm	inch	mm	inch
90	3.5	100	4	150	6	150	6	250	10

Use the largest possible backbending radius for elevators with side guards or hold down devices.